

THIS DRAWING MAY BE USED ONLY FOR THE PURPOSE INTENDED AND ONLY WRITTEN DIMENSIONS SHALL BE USED

NOTES

- ALL DIMENSIONS ARE IN MILLIMETRES UNLESS STATED OTHERWISE.
- THE GENERAL SPECIFICATION OF MATERIALS AND WORKMANSHIP FOR THE CONSTRUCTION OF THE ACCESS ROAD, FOOTPATHS AND OTHER AREAS OF HARDSTANDING SHALL BE THE MANUAL OF CONTRACT DOCUMENTS FOR HIGHWAY WORKS, VOLUME 1, SPECIFICATION OF HIGHWAY WORKS (SHW) PUBLISHED BY THE STATIONARY OFFICE, MARCH 1998 AND ALL SUBSEQUENT REVIEWS.
- ALL MATERIALS UNLESS SPECIFIED OTHERWISE, SHALL COMPLY WITH RELEVANT BRITISH STANDARDS. SOURCES OF MATERIALS ARE TO BE AGREED WITH THE ADOPTING AUTHORITY IN ADVANCE OF THE WORKS.
- THIS DRAWING IS TO BE READ IN CONJUNCTION WITH ALL ASSOCIATED ENGINEERS DRAWINGS AND DETAILS.
- ANY DISCREPANCIES IN THE DETAILS SHOWN ON THIS DRAWING TO BE REPORTED TO THE ENGINEER PRIOR TO CONSTRUCTION.

ROAD CONSTRUCTION

6. SUB-BASE THICKNESS TO BE AS INDICATED BELOW:-

CBR VALUE OF FORMATION	LAYER THICKNESS
CBR GREATER THAN 15%	150mm SUB-BASE
CBR GREATER THAN 5% BUT LESS THAN 15%	150mm SUB-BASE LAID IN 2 LAYERS (MAX. SINGLE LAYER THICKNESS 125mm)
CBR GREATER THAN 2% BUT LESS THAN 5%	225mm SUB-BASE PLUS 350mm CAPPING
CBR LESS THAN 2%	150mm SUB-BASE PLUS 600mm CAPPING

- ANY SOFT SPOTS AT UNDERSIDE OF CAPPING LAYER TO BE TREATED BY OVERDIGGING AND REPLACEMENT WITH AN APPROVED COMPACTED GRANULAR MATERIAL.
- THE FORMATION OF ROADS AND FOOTWAYS SHALL BE PREPARED BY REMOVING ALL UNSUITABLE MATERIAL AND AN APPROVED WEEDKILLER SHALL BE SPRAYED ONTO THE SUBGRADE BEFORE LAYING THE SUB-BASE.
- PRIOR TO CARRYING OUT ANY WORKS ON A PUBLIC HIGHWAY THE CONTRACTOR SHALL OBTAIN A ROAD OPENING PERMIT FROM THE HIGHWAY AUTHORITY.
- TRAFFIC SAFETY MEASURES ON OR ADJACENT TO AN EXISTING HIGHWAY SHALL BE IN ACCORDANCE WITH CHAPTER 8 OF THE TRAFFIC SIGNS MANUAL.
- WHERE NEW PAVEMENT MATERIALS ARE TO BE LAID AGAINST EXISTING BOUND MATERIALS, THE EXISTING SURFACE SHALL BE SAW CUT TO A STRAIGHT EDGE AND THE VERTICAL FACE PAINTED WITH BITUMEN EMULSION SEALANT.
- WHERE NEW PAVEMENT MATERIALS ARE TO BE LAID UPON EXISTING BOUND MATERIALS, THE SURFACE OF THE EXISTING MATERIAL SHALL BE SUCTION SWEEPED AND TACK COATED IN ACCORDANCE WITH CLAUSE 920 (SHW).
- BEDDING AND BACKING TO KERB AND EDGING TO BE DESIGNATED MIX GEN 3 TO BS500-1:2002.
- ALL BITUMINOUS MACADAM LAYERS SHALL BE COMPACTED TO ACHIEVE THE AIR VOIDS REQUIREMENTS SPECIFIED IN THE RELEVANT SECTIONS OF BS 4987.
- CONCRETE MIXES INDICATED ON THIS DRAWING ARE DESIGNATED MIXES CONFORMING TO BS8500-1:2002.

PEDESTRIAN CROSSING

- TACTILE PAVING TO BE BUFF IN COLOUR LAID ON 50 THICK CEMENT MORTAR TO DESIGNATION (i) OF SHW CLAUSE 2404 ON 75 TYPE 1 SUB-BASE.
- CENTRAL KERBS OVER CROSSING TO BE FLUSH WITH CARRIAGEWAY OR NOT GREATER THAN 6mm.
- GRADIENT OF TACTILE SURFACING SHALL NOT BE GREATER THAN 1 IN 12.

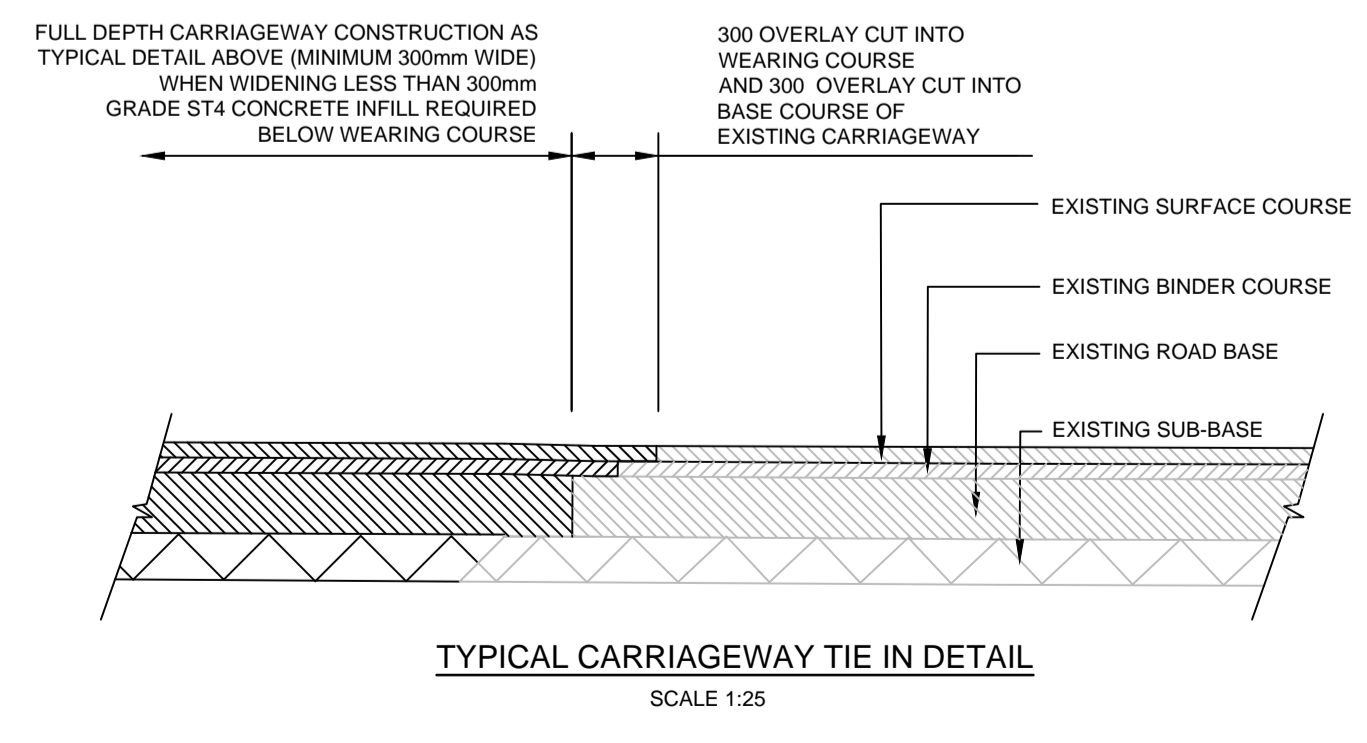
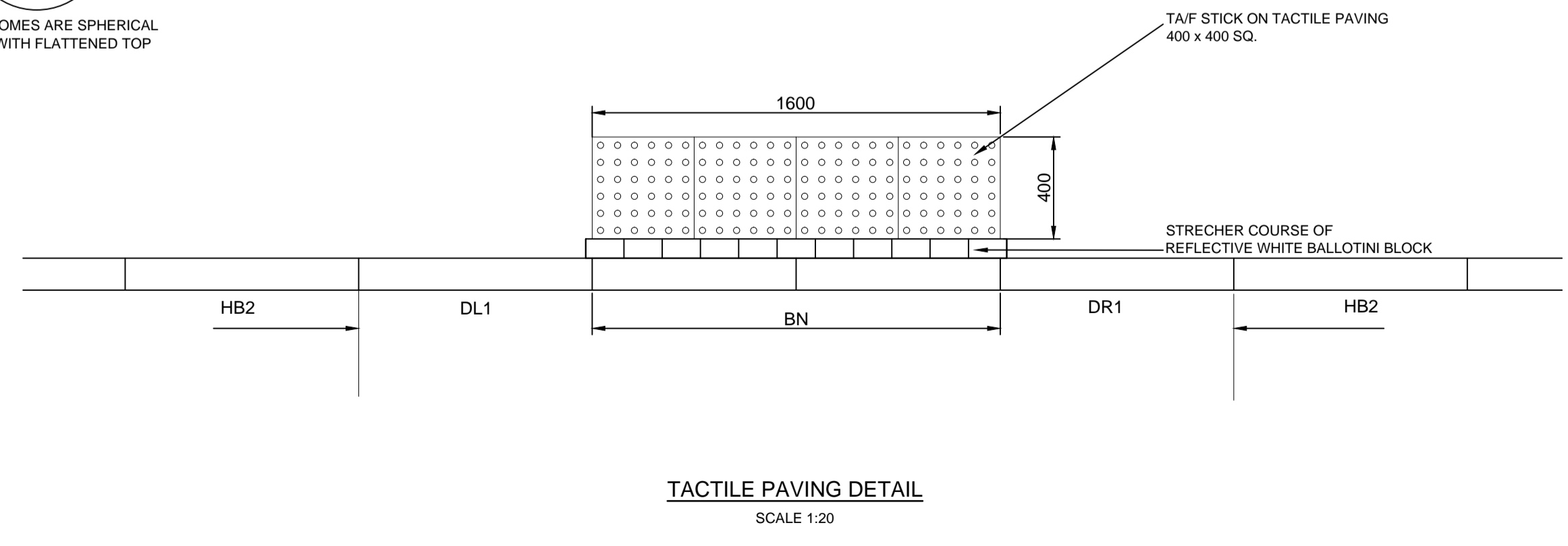
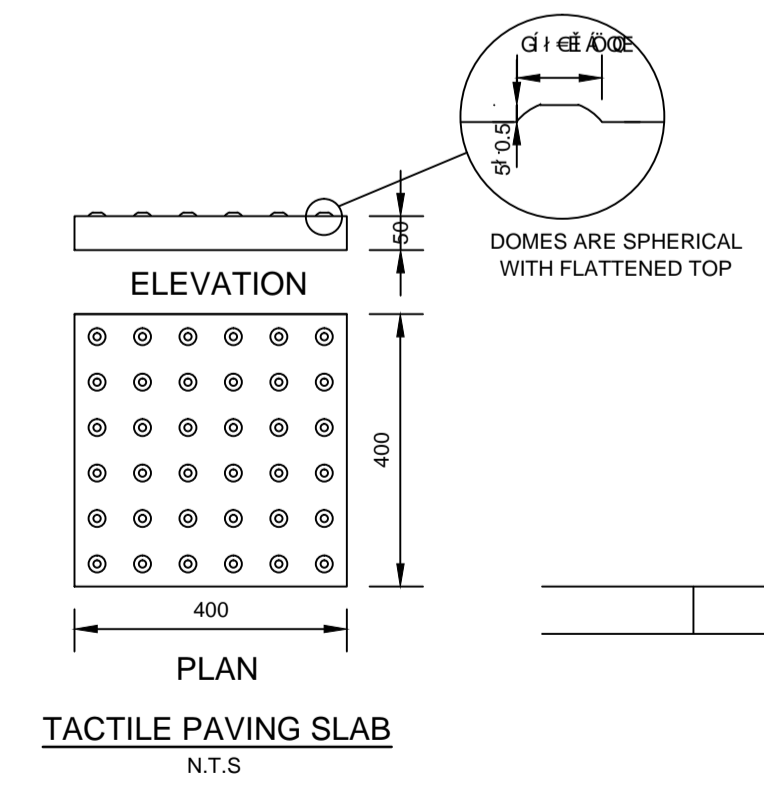
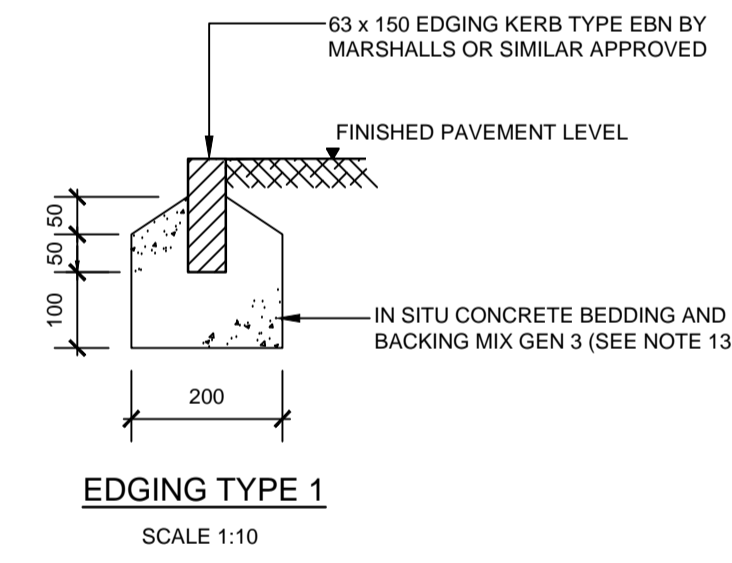
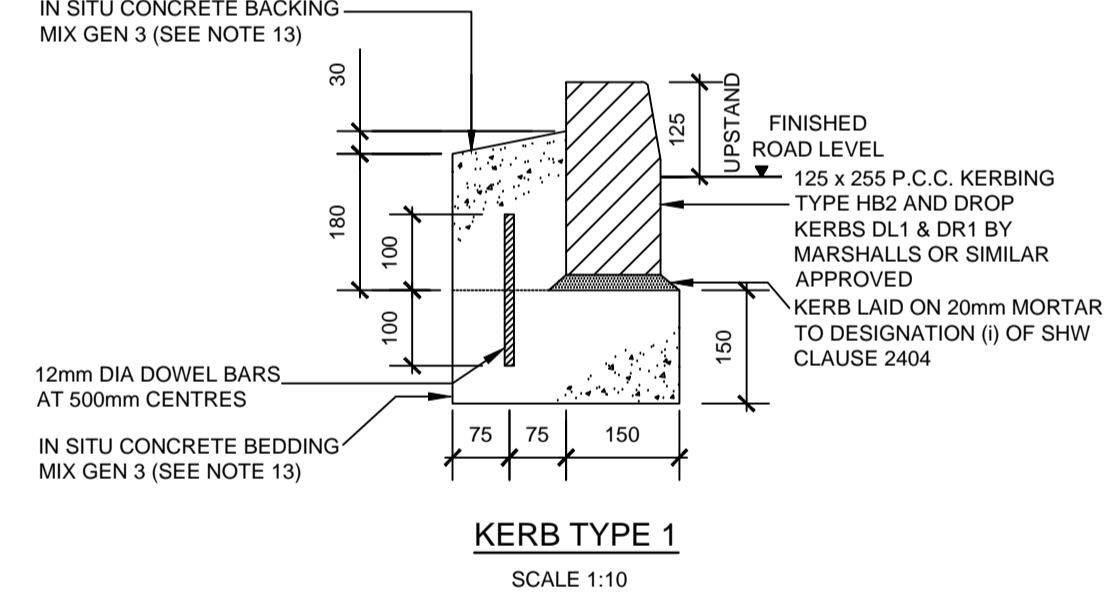
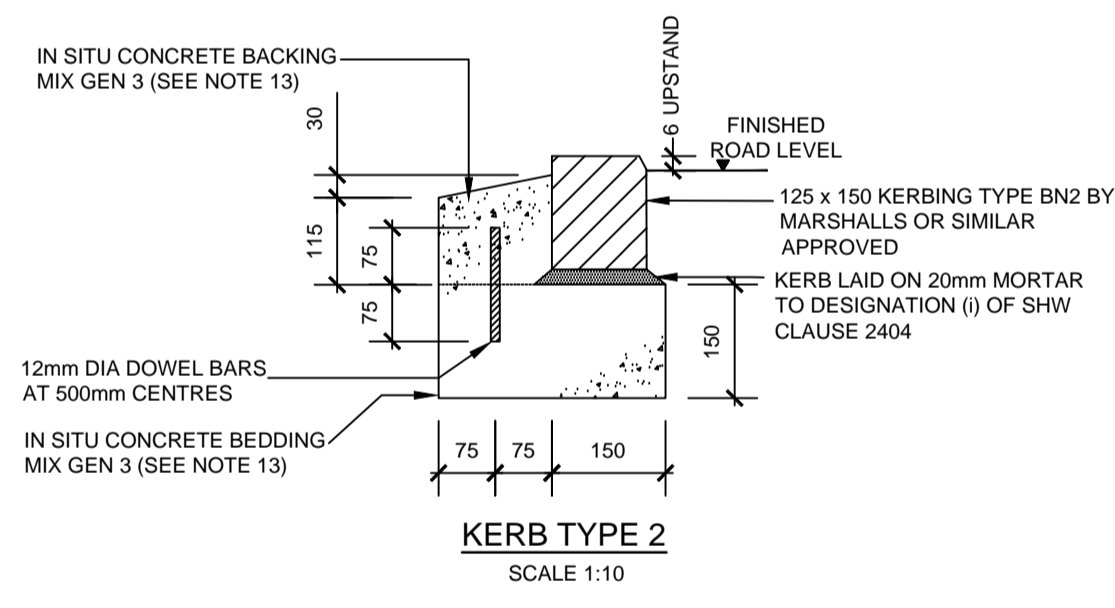
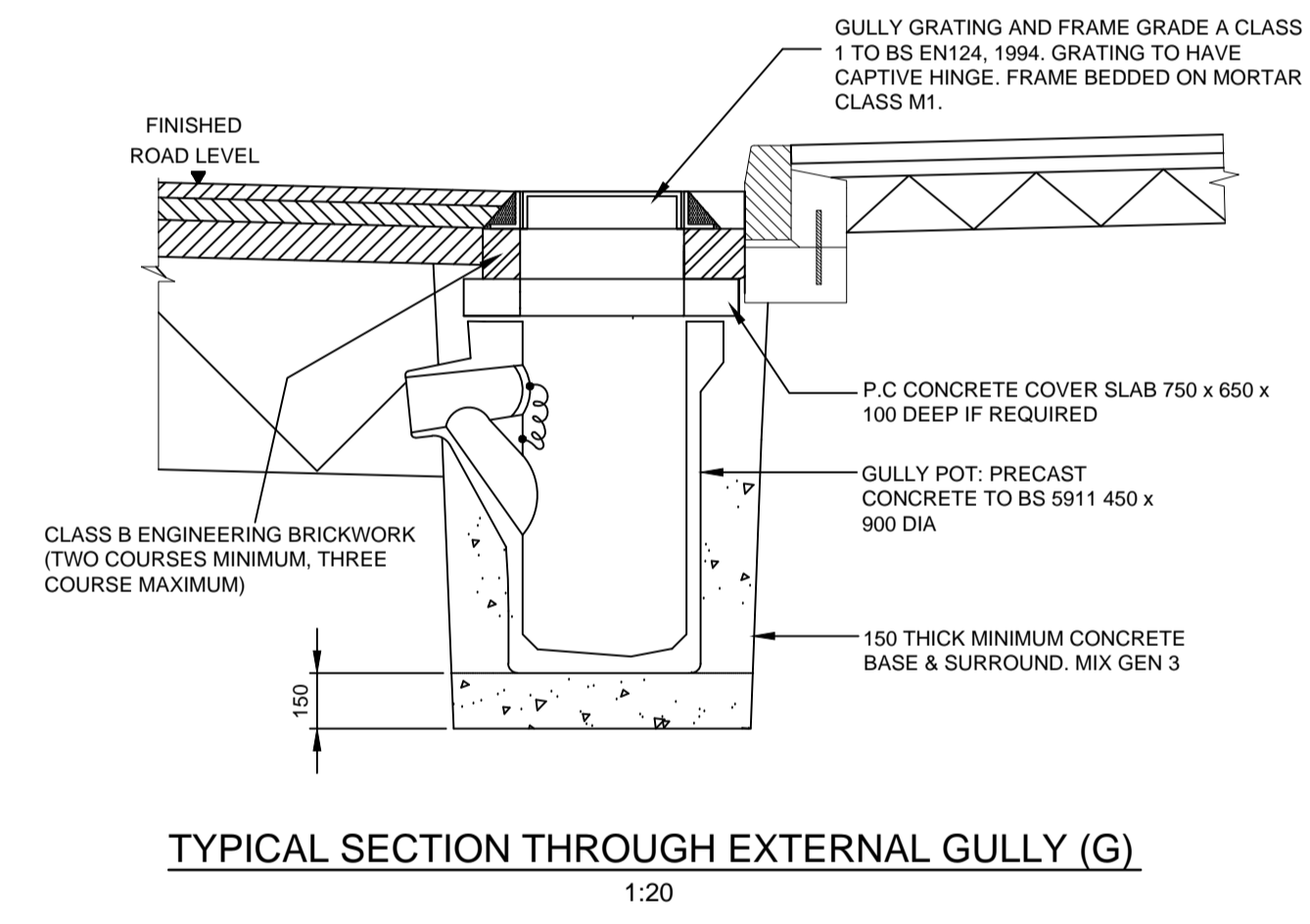
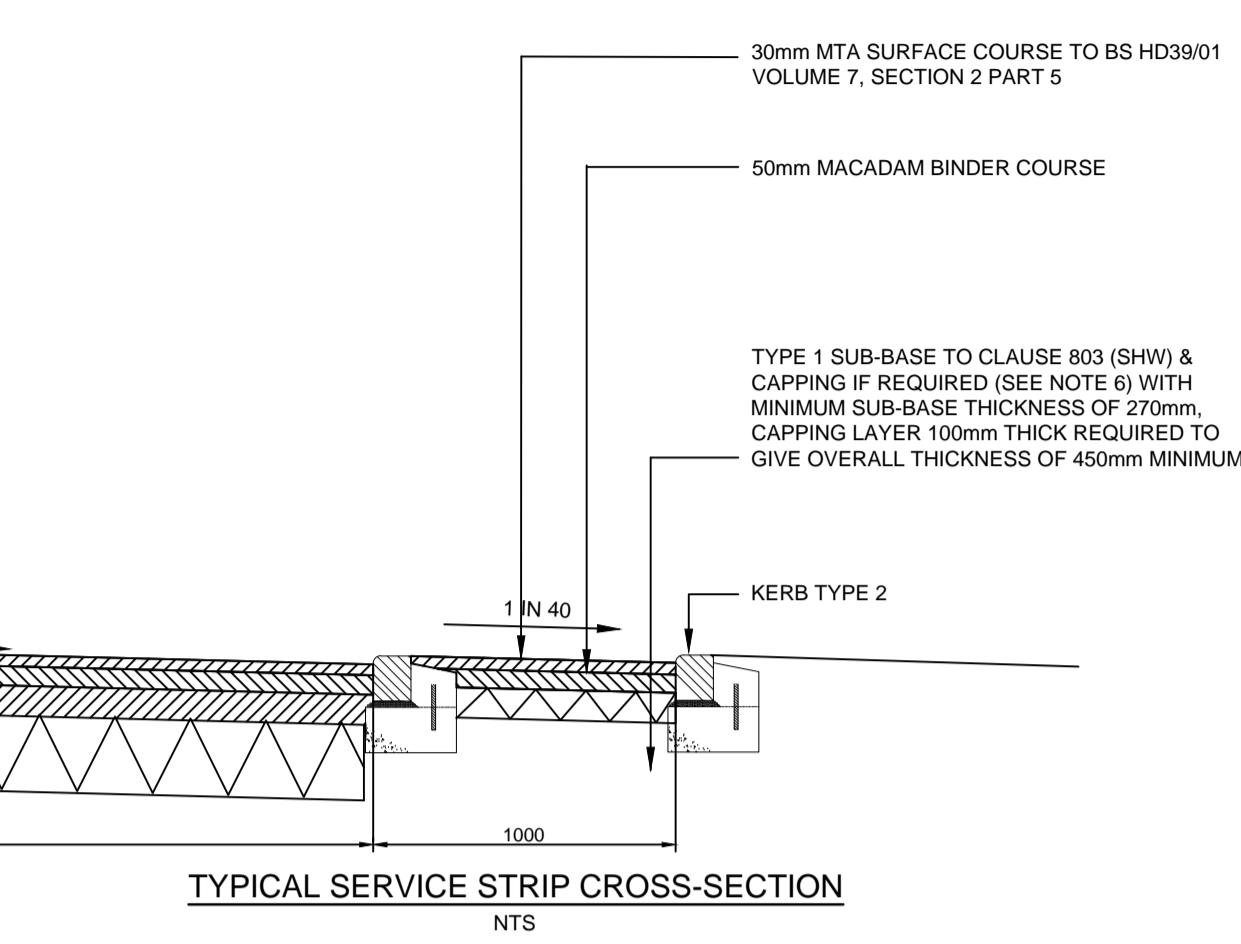
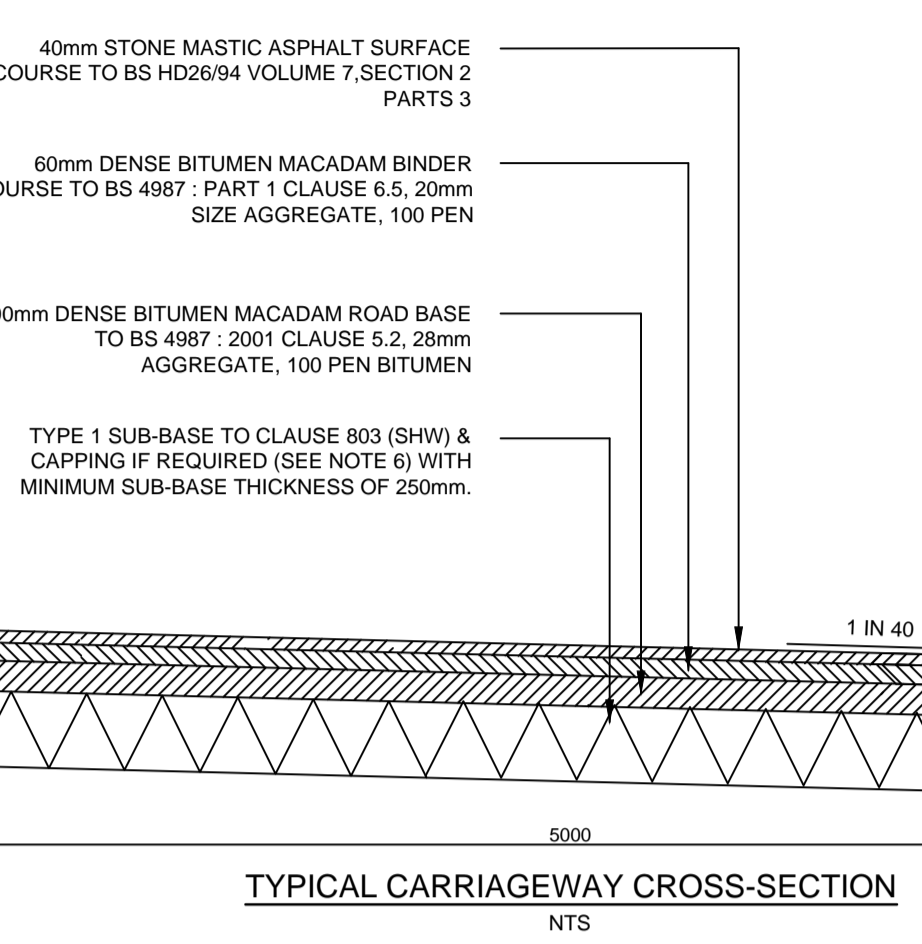
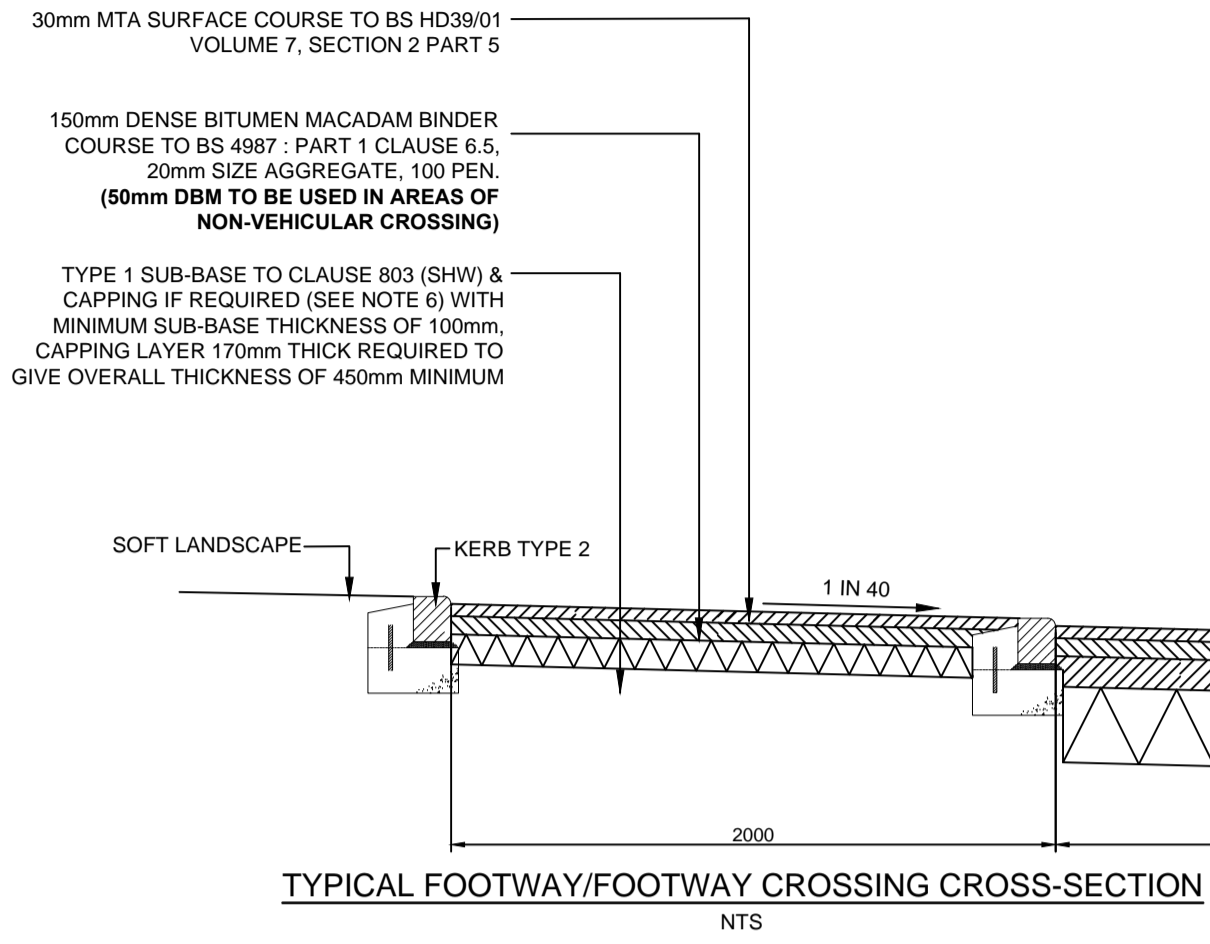
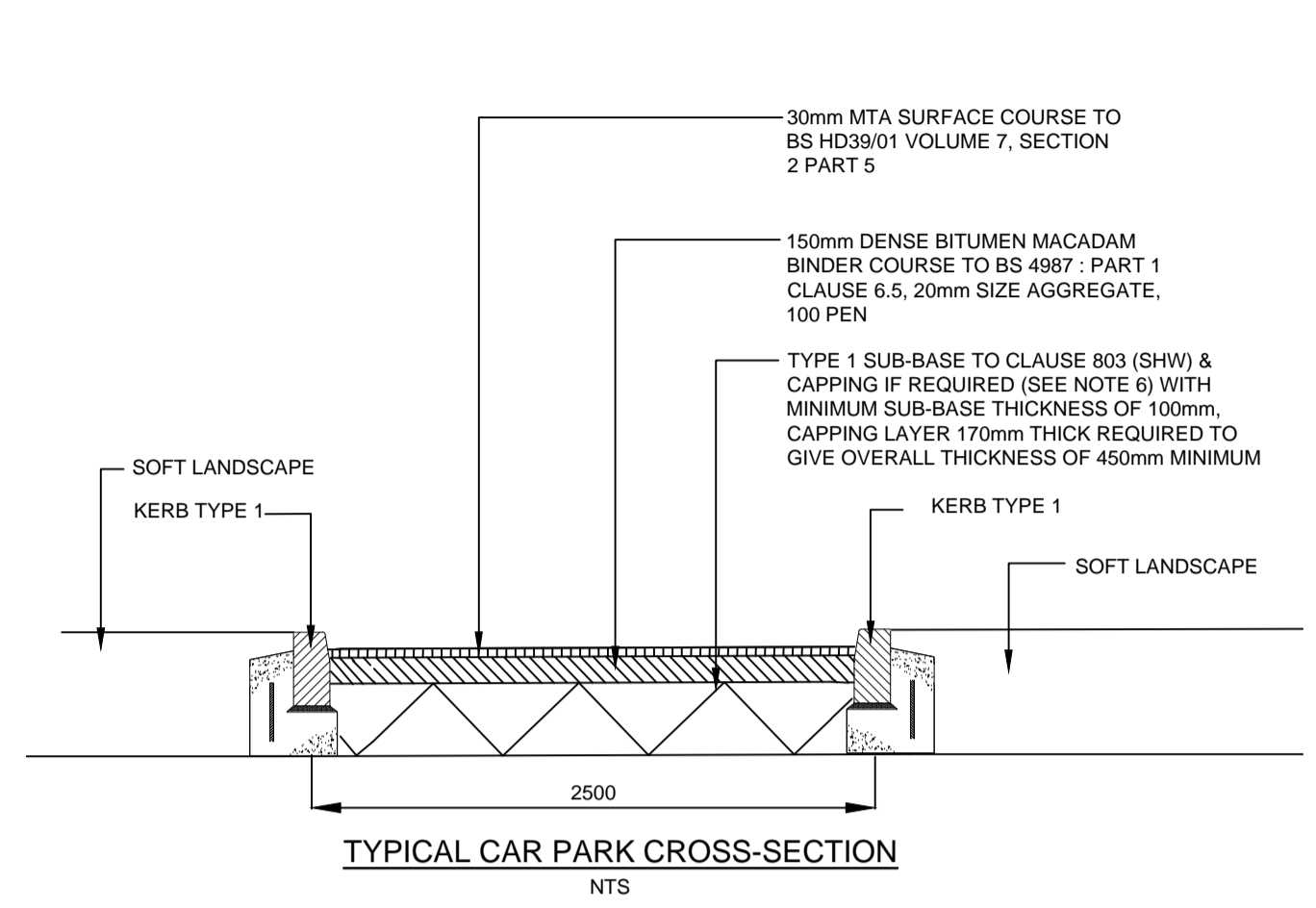

Revision	Details	By	Check	Date	Suffix

Drawing Number: **J01026/A1/005**

**BENTLEY ROAD
NORTH
WALSALL**

Drawing Title:
**ROAD CONSTRUCTION
DETAILS**

Scale at A1	Detailed	Approved
1:200		James Mewis
Drawn	Tech Chk	Det Chk
RJS	JJM	JJM
		Date
		22.10.07

www.jnmengineering.co.uk
84 Lloyds Head, Jackfield
Ironbridge, TF8 7LZ.
Tel: 01952 885767
info@jnmengineering.co.uk
Company Registration Number: 05782540