

# ECG – Egg Crate Grilles

Egg crate grilles offer a 90% free area, very low noise levels and minimal pressure drops. These facts have helped make egg crate grilles the industry standard extract grille, perfect for a huge range of applications.

Egg crates are not recommended for use as supply grilles however, due to their poor diffusion characteristics.

**Construction:** Extruded aluminium frame and aluminium core.

Pressed aluminium corners in joints

**Options & Accessories:** M & M Access Ltd can supply a standard Egg Crate Grille or a customised grille made to your exact specifications.

**Opposed blade damper** – Operated via key/screwdriver through face of grille.

**Removable or hinged core** – Making maintenance and duct access faster and easier.

**Filter media** – Fixed to back of grille, for the prevention of airborne particles entering the ventilation system.

**Finishes** – M & M Access Ltd can polyester powder coat or nylon coat your Egg Crate Grille to any RAL or BS colour, non painted finishes are mill or satin anodised (SAA).

**Light baffle plate** – Should a grille be fitted to prevent a break in a pattern or series, yet not be connected to ductwork, we offer a light baffle plate to prevent line of sight into the ceiling void above.

**Specialised tiles** – M & M Access Ltd can cater for situations where specific tile formats are needed. Please get in touch with our sales team for more information on ECG's fitted into tile layouts such as Burgess clip in systems.

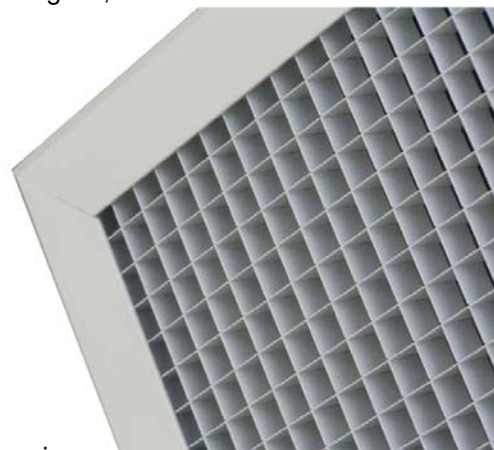

## Fixing Instructions

### FIXING HOLES

When using countersunk fixing holes connect the reverse of the grille to the ductwork. Then, simply fix the grille to the wall or ceiling using the supplied screws.

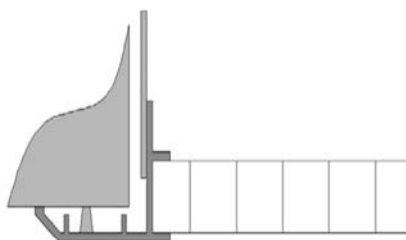

### CONCEALED FIXINGS

If using concealed fixings, fix the top 'L' bracket to the inside of the ductwork. Use the supplied bolt to then bolt the lower 'L' riveted to the grille, to the upper 'L' inside the duct.

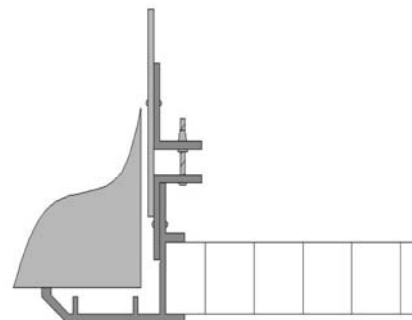

### BURGESS / OTHER TILE SYSTEM

The grille will be fitted into the tile before despatch. Installation then involves connecting the reverse of the grille to ductwork, and clipping the burgess tile into the pre-prepared ceiling grid.

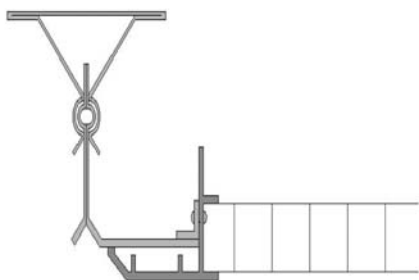

### LAY IN

Simply lay the grille into the pre-prepared T bar ceiling grid and then through the face, connect the diffuser to the ductwork. Please note that a lay in grille would be manufactured with a 25mm flat flange as standard.

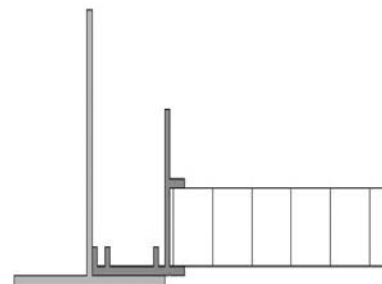

# Technical Information

- Free area - Approximately 90%
- ECG        Mass / M<sup>2</sup> - 7.5 KG
- ECG/D     Mass / M<sup>2</sup> - 15.5 KG

- Egg Crate Grille with no OBD and standard 32mm bevelled flange.

\_\_\_ x \_\_\_ - EGC - STD

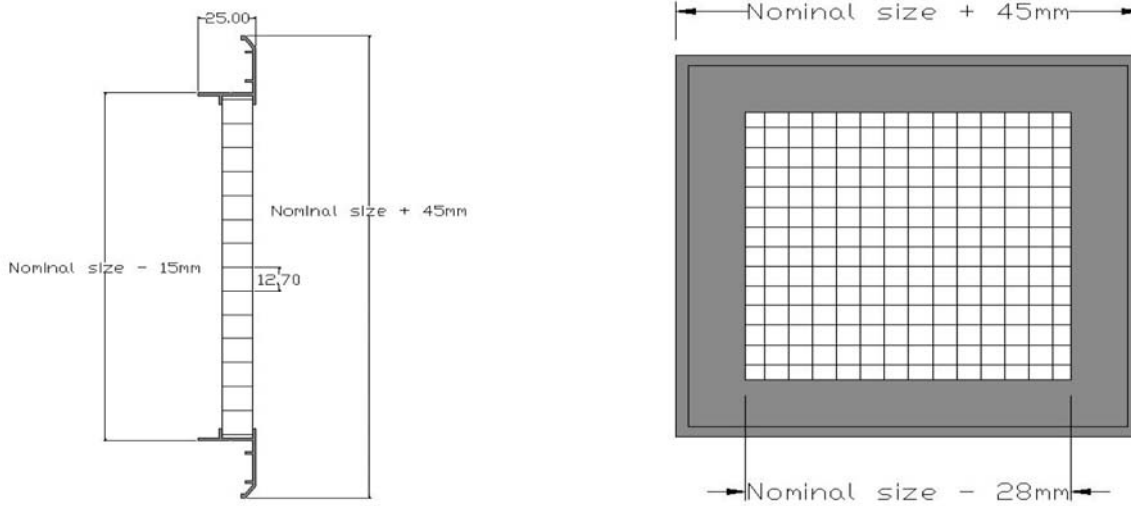

- Egg Crate Grille with 32mm bevelled flange, complete with OBD.

\_\_\_ x \_\_\_ - ECG - STD - D

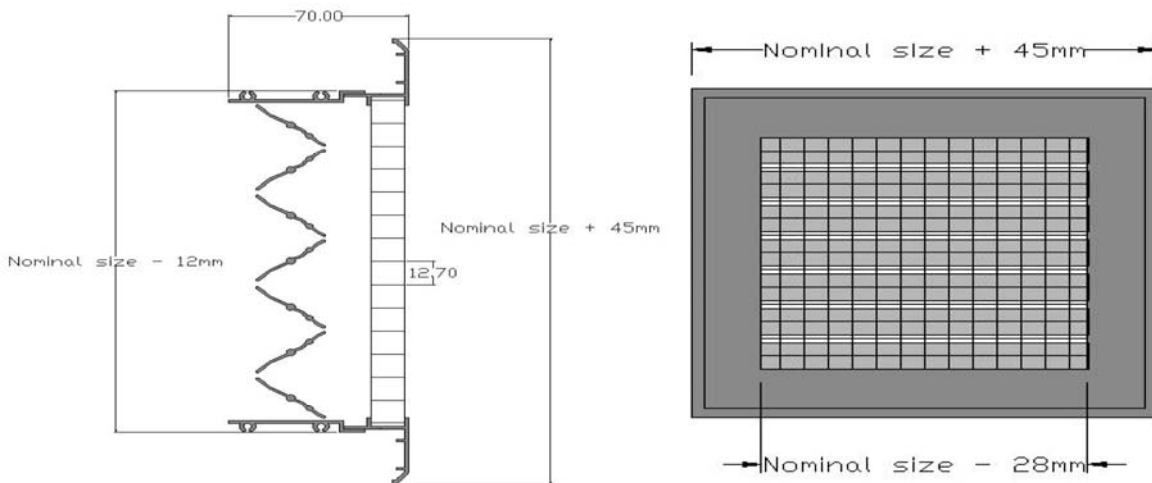

- Egg Crate Grille with removable core, no OBD and standard 32mm bevelled flange.

\_\_\_ x \_\_\_ - EGC - STD - RC

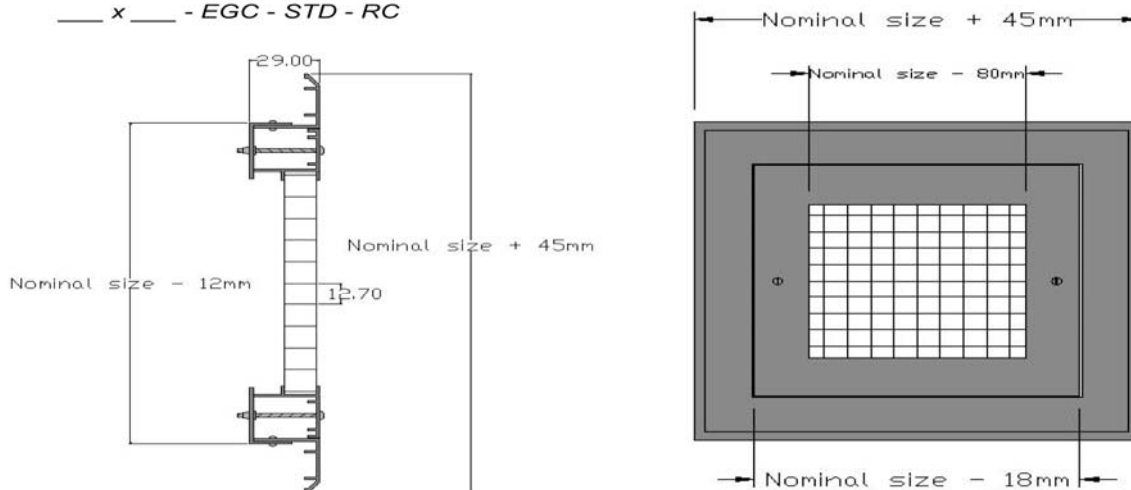

• Egg Crate Grille with hinged core, no OBD and standard 32mm bevelled flange.

Please note screw fixing on non hinged side is not standard method, CAM fasteners would be used as standard unless specified.

\_\_\_ x \_\_\_ - EGC - STD - HC

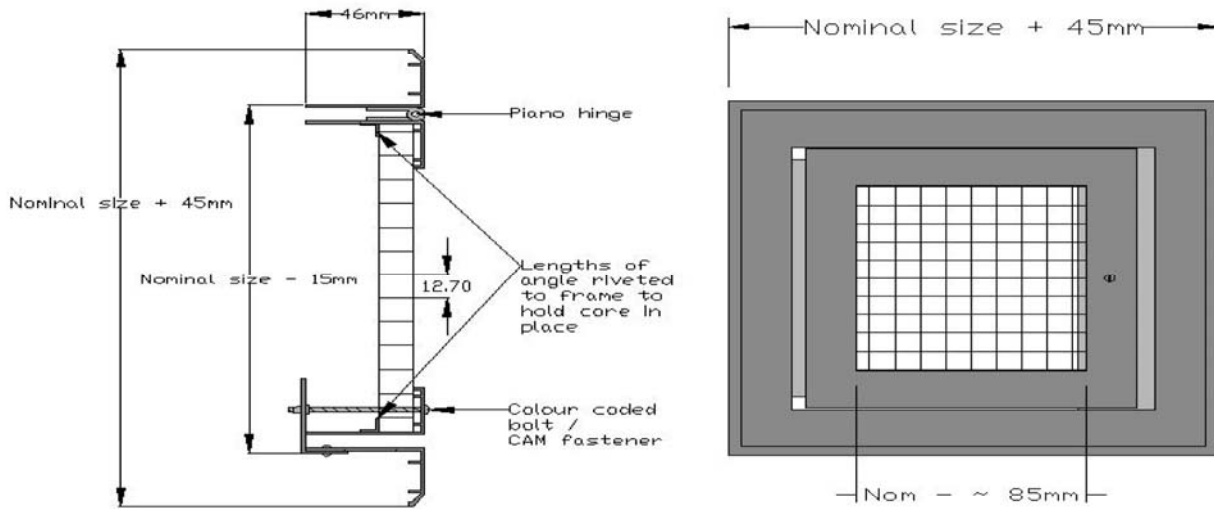

• Egg Crate Grille with 25mm flat flange.

\_\_\_ x \_\_\_ - EGC - 25 - STD

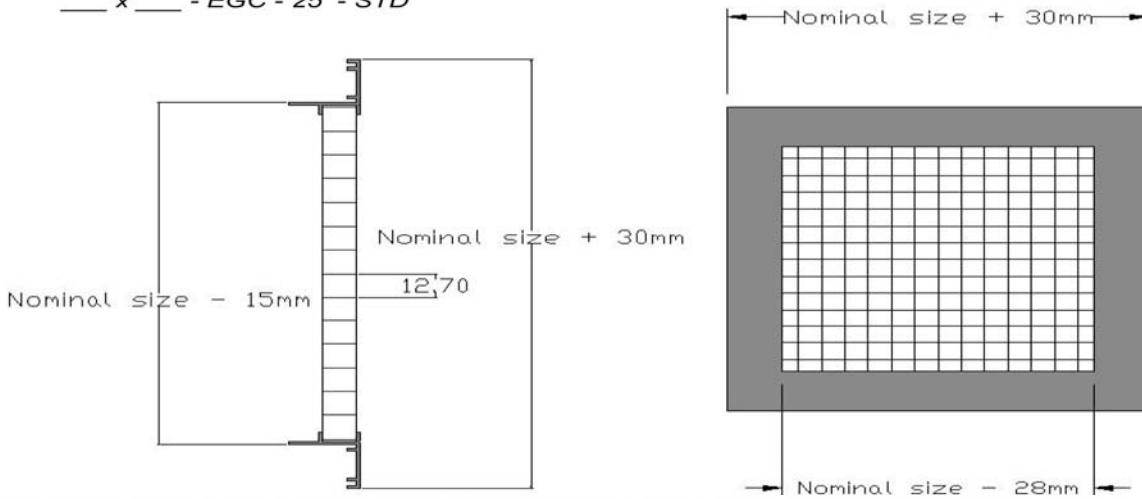

**Frame types**

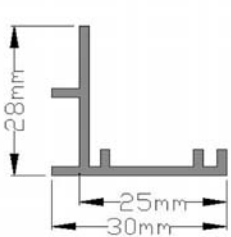

25mm flat flange

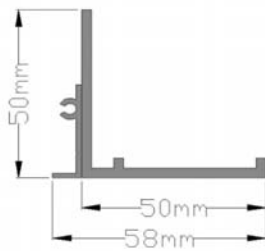

50mm flat flange

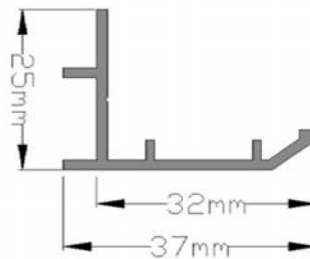

32mm bevelled flange

**M & M Access Ltd**  
**5 Quarry Park Close**  
**Moulton Park Industrial Estate**  
**Northampton**  
**NN3 6QB**

**Tel: 01604 644944 Fax: 01604 644899**

**Email: sales@m-maccess.co.uk**

**Web: www.m-maccess.co.uk / www.access-panels.com**